

Show next page (Right Arrow)

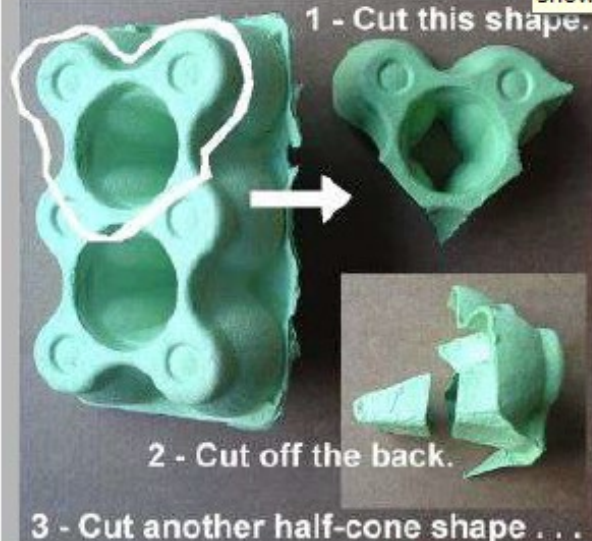

This has been an  
 "art jumpstart"  
 by Darrell Wakelam  
**Egg Box Monkey**

1 - Carefully cut out this shape.



2 - Cut the beak shape.

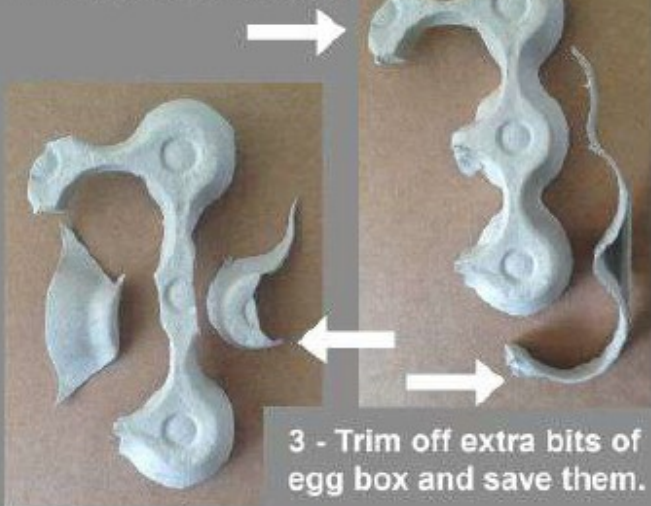

3 - Trim off extra bits of egg box and save them.



4 - Attach this piece to a base leaving plenty of room for the long legs.

I have ripped and scratched the bottom of the card base to make it look like water . . .

5 - Roll up a thin piece of tin foil or thin paper to make the legs . . . add toes to the foot that is raised up but leave the other . . .



6 - Use the extra pieces of egg box to build up the body.



7 - Roll up some more tin foil to make 'ripples' in the water . . .

Now it's ready for you to add some colour.



# Egg Box Flamingo

This has been an "art jumpstart" by Darrell Wakelam

